

CERTIFIED RECORD OF LAND CORNER MONUMENTATION

N-23

History of original corner establishment:

1884, Herman D. Gradon, under contract No. 499, established the corner. He set a post 3' long, 3" square 24" in the ground, from which:
5" Spruce bears, N. 35° W., 14 lks.
5" Fir bears, S. 26° E., 13 lks.

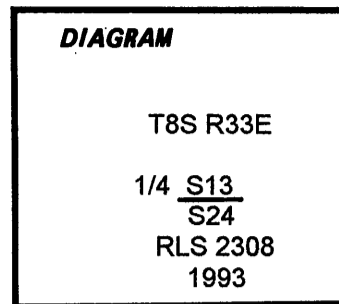

Description of corner evidence found:

Found the NW BT:
16" Lodgepole Pine snag bears N. 35° W., 14 lks. (9.2 feet) with scribe mark "S" visible on the remains of the original blaze.

Description of monument and accessories I established to perpetuate the original location of this corner:

At record bearing and distance from the found BT, I set a 2 1/2" by 30" aluminum pipe, with a 3 1/4" aluminum cap, 14" in the ground and placed a 3' by 1 1/2' high rock mound around the monument.

Marked New BT's:

- 19" Western Larch bears, N. 21° E., 11.4 feet, marked "1/4 S13" "BT".
- 7" Lodgepole Pine bears, S. 88 1/2° E., 29.4 feet, marked "1/4 S24" "BT".
- 11" Grand Fir bears, S. 44° W., 35.6 feet, marked "1/4 S24" "BT".
- 17" Grand Fir bears, S. 82° W., 40.4 feet, marked "1/4 S24" "BT".

New BT's are double blazed and have a brass washer stamped "RLS 2308" Nailed to the lower blaze by the "BT" scribing.

Magnetic Declination: 20° East

Work Performed BY: David A. Schlaich (RLS 2308)
Witnessed By: Chris Merrifield

Date: June 1993

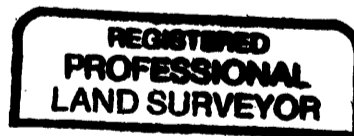

David A. Schlaich

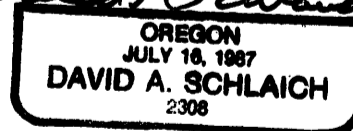

Office of... Surveyor County of... Grant
State of... Oregon, I hereby certify that the within instrument was filed in this office
for record on the... 2... day of... Feb, 19... 94
Robert D. Baggett by
(COUNTY OFFICIAL) (DEPUTY)